

PCB LAYOUT
S=2.5:1

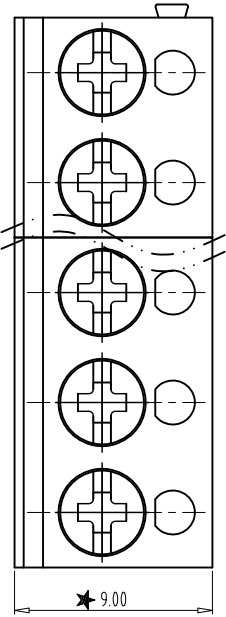

- NOTES:
1. Rating: 300V 12A
 2. Insulation Withstands Voltage: AC2000V/MIN
 3. Insulation Resistance: 500MΩ or more at DC500V
 4. Using Temperature Range: -40°C--+105°C
 5. Screw Torque Value: 0.5N.m
 6. Suitable Electric Wire: 22-14AWG
 7. "★" is the important dimension.
 8. Housing: PBT (UL94-V0);
 9. Pin header: Brass, Ni plated;
 10. Screw: Steel, Zinc plated;
 11. Shrapnel: Stainless steel;

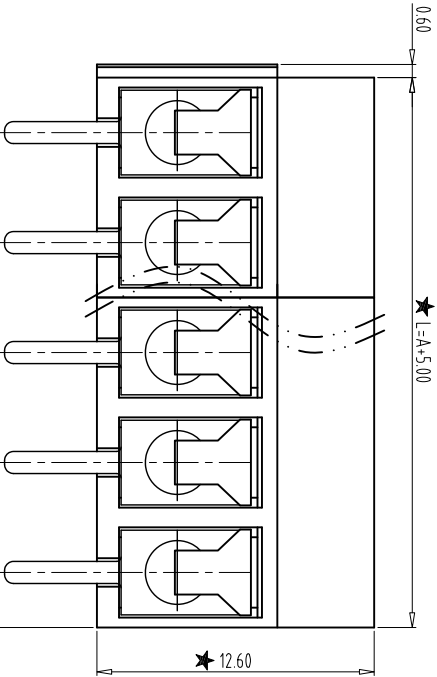

SECTION:A-A

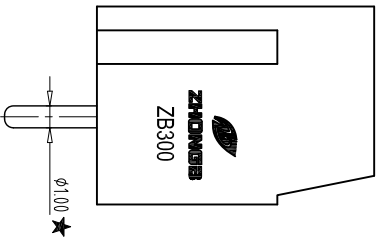
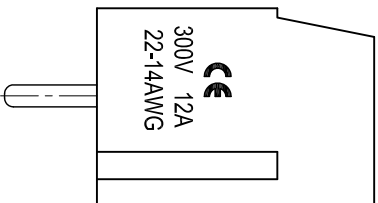
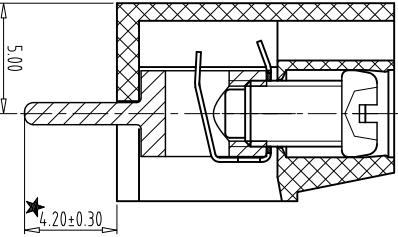

Total Pitch Tolerances		Nominal dimension range																											
In mm																													
0	30	53	70	90	115	150	200	250	300	0	30	53	70	90	115	150	200	250	300	0	0.2	0.3	0.3	0.2	0.3	0.3	0.2	0.3	0.5
to	to	to	to	to	to	to	to	to	to	to	to	to	to	to	to	to	to	to	to	to	to	to	to	to	to	to	to	to	to
30	53	70	90	115	150	200	250	320	300	30	53	70	90	115	150	200	250	320	10	10	100	100	150	150	150	150	150	150	150

ITEM	NAME OF PART	NO. OF PART	Q'TY	MATERIAL	NOTE
DWG	SK	DATE	14.05.27	mm	SHEET/OF
CHK		DATE		SCALE	3 : 1
APP.		DATE		NAME	ZB104V-XXP-XC(ZB300-5.0)